

BUSCHMAN PROPERTIES

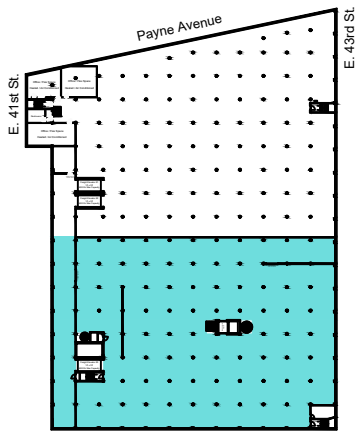

4100 Payne Avenue
Cleveland, OH 44103
(216) 431 6633



3rd Floor - South Half - 39,000 SF

The South half of this floor provides a generous 39,000 square feet of adaptable space, ideal for a wide range of business uses. This expansive area is well-lit with energy-efficient LED lighting, creating a productive and bright environment. While it currently does not feature built-in offices or a bathroom, it offers ample opportunity for customization to meet specific operational needs. A key feature of this space is its direct access to a large freight elevator, measuring 10' x 20' with a 6,000-pound capacity, which greatly enhances the ease of moving goods and equipment. This sizable area is perfect for businesses in need of a vast, flexible workspace with convenient logistical capabilities.

For more information contact
sales@buschman-properties.com

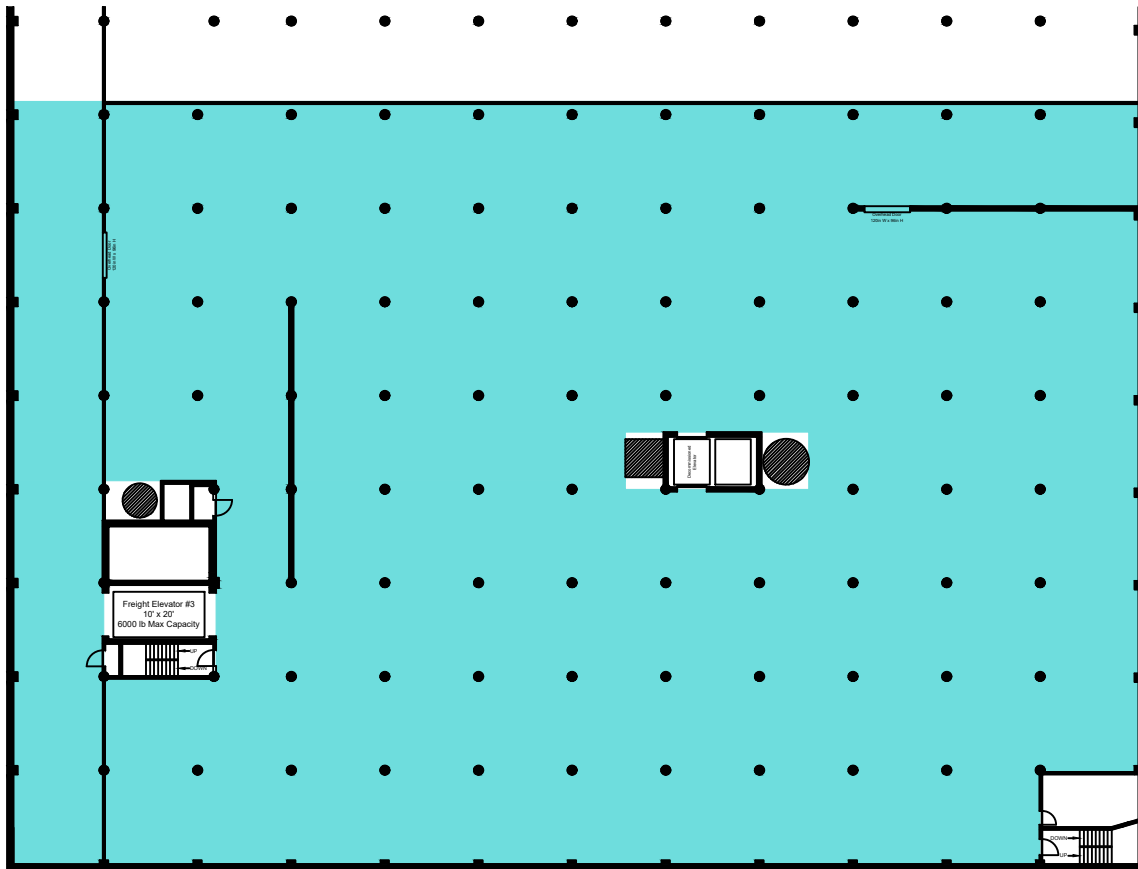

Scale: 0 10 25 50 100 Feet